

# EchoPanel® Paling

**Designer:** Woven Image

**Application(s):** Partitions

## Composition & Pattern

**Composition** 100% PET (60% post-consumer recycled)

**Hardware Composition** ABS Plastic

**Colours Available** 3

## Kit & Box Content

**Box Contents** EchoPanel pieces & Joiners of your choice

## Dimensions & Weight

**Dimensions** Height: 1750 (+/- 2mm), Width: 285 (+/- 2mm), Thickness: 24mm  
(+/- 7% Joiner straight: 195 x 25 x 28mm Joiner 90: 128.2 x 128.2 x 25 x 28mm Joiner 120: 198 x 25 x 28mm Joiner 150: 204 x 25 x 28mm Joiner T: 195 x 128 x 25 x 28mm Joiner X: 228 x 228 x 25 x 28mm Joiner Y: 198 x 198 x 25 x 28mm Joiners are available in either Cream, Charcoal, Copper or Chrome

**Unit of Sale** Piece

**Unit of Sale Net Weight (kg)** 3.8

## Performance

<b>Fire Test Result</b>	ISO 9705: Group 1, BS EN 13501.1: Classification B - s1, d0, ASTM E84 Unadhered: Class 1 or A
<b>Acoustic Performance Standard Test Method</b>	AS ISO 354: 2006 (R2016)
<b>Noise Reduction Coefficient (NRC) Result</b>	EchoPanel® 24mm achieves: Direct fix: 0.65, 20mm air gap: 0.75, 50mm air gap: 0.85
<b>Sound Absorption Average (SAA) Result</b>	EchoPanel® 24mm achieves: Direct fix: 0.63
<b>Weighted Sound Absorption Coefficient (<math>\alpha_w</math>) Result</b>	EchoPanel® 24mm achieves: Direct fix: 0.45 (MH), 20mm air gap: 0.50 (MH), 50mm air gap: 0.70 (MH)
<b>Sound Absorption Class</b>	D (Direct fix)
<b>Additional Acoustic Information</b>	Sound Absorption Class result is based on EchoPanel® 24mm. MH = Mid to High Frequency
<b>Colour Fastness to Light Standard Test Method</b>	ISO 105 B02
<b>Colour Fastness Light Rating</b>	6 - 7

## Sustainability

<b>VOC Emissions Results</b>	EchoPanel 24mm achieves ASTM D5116: TVOC Emissions Rate: $<0.02\text{mg}/\text{m}^2/\text{hr}$ (7 days), and CDPH Standard Method v1.2: TVOC Emissions Rate: $<0.054\text{mg}/\text{m}^3$ ; Formaldehyde Emissions Rate: $<2\mu\text{g}/\text{m}^3$
<b>Sustainability Performance</b>	
<b>Sustainability Performance Details</b>	EchoPanel achieves GreenTag Certification GreenRate: Level A &

Health Rate Platinum, Red List Free, and has an International Living Future Institute Declare Label.

Instructions

**Additional Information** See Woven Image EchoPanel® Care & Cleaning Guide.

Exact colour matching cannot be guaranteed between batches. Fibre mix and web variation are natural characteristics of this product.

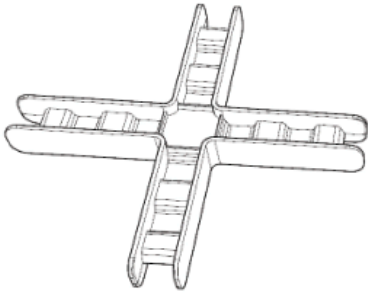

Joiner X

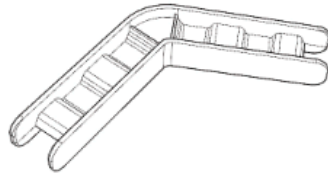

Joiner 120

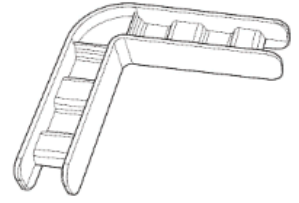

Joiner 90

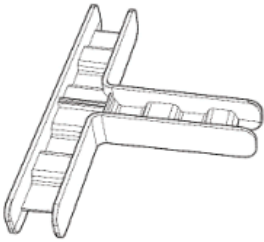

Joiner T

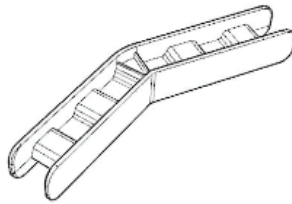

Joiner 150

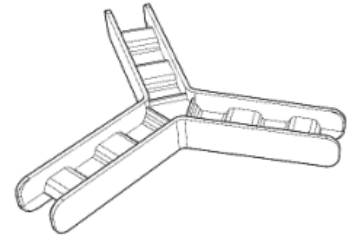

Joiner Y

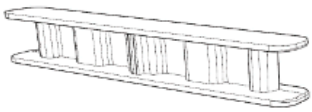

Joiner Straight

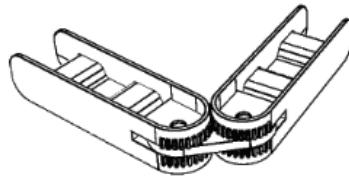

Joiner Pivot

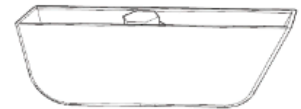

Foot Adjuster



**Paling A**  
285 x 1750mm



**Paling B**  
285 x 1750mm