

EchoPanel® Wrap

Designer: Bang Design in collaboration with Woven Image

Application(s): Partitions

Composition & Pattern

Composition 100% PET (60% post-consumer recycled)

Hardware Composition ABS Plastic

Colours Available 3

Kit & Box Content

Box Contents EchoPanel pieces & Joiners of your choice

Dimensions & Weight

Dimensions Wrap A: Height: 1650 (+/- 2mm), Width: 475 (+/- 2mm), Thickness: 24mm (+/- 7%) Wrap B: Height: 1400 (+/- 2mm), Width: 464.5 (+/- 2mm), Thickness: 24mm (+/- 7%) Wrap C: Height: 1650 (+/- 2mm), Width: 780 (+/- 2mm), Thickness: 24mm (+/- 7%) Wrap C2: Height: 1650 (+/- 2mm), Width: 780 (+/- 2mm), Thickness: 24mm (+/- 7%) Wrap D: Height: 1400 (+/- 2mm), Width: 780 (+/- 2mm), Thickness: 24mm (+/- 7%) Wrap D2: Height: 1400 (+/- 2mm), Width: 780 (+/- 2mm), Thickness: 24mm (+/- 7%) Wrap E: Height: 1650 (+/- 2mm), Width: 780 (+/- 2mm), Thickness: 24mm (+/- 7%) Joiner straight: 195 x 25 x 28mm Joiner 90: 128.2 x 128.2 x 25 x 28mm Joiner 120: 198 x 25 x 28mm Joiner 150: 204 x 25 x 28mm Joiner T: 195 x 128 x 25 x 28mm Joiner X: 228 x 228 x 25 x 28mm Joiner Y: 198 x 198 x 25 x 28mm Foot/Adjuster: 147 x 49 x 25 x 28mm Joiners are available

in either Cream, Charcoal, Copper or Chrome

Unit of Sale Piece

Unit of Sale Net Weight (kg) 3.8

Performance

Fire Test Result ISO 9705: Group 1, BS EN 13501.1: Classification B - s1, d0, ASTM E84 Unadhered: Class 1 or A

Acoustic Performance Standard Test Method AS ISO 354: 2006 (R2016)

Noise Reduction Coefficient (NRC) Result EchoPanel® 24mm achieves:
Direct fix: 0.65, 20mm air gap: 0.75, 50mm air gap: 0.85

Sound Absorption Average (SAA) Result EchoPanel® 24mm achieves:
Direct fix: 0.63

Weighted Sound Absorption Coefficient (α_w) Result EchoPanel® 24mm achieves: Direct fix: 0.45 (MH), 20mm air gap: 0.50 (MH), 50mm air gap: 0.70 (MH)

Sound Absorption Class D (Direct fix)

Additional Acoustic Information Sound Absorption Class result is based on EchoPanel® 24mm. MH = Mid to High Frequency

Colour Fastness to Light Standard Test Method ISO 105 B02

Colour Fastness Light Rating 6 - 7

Sustainability

VOC Emissions Results EchoPanel 24mm achieves ASTM D5116: TVOC Emissions Rate: <0.02mg/m²/hr (7 days), and CDPH Standard Method v1.2: TVOC Emissions Rate: <0.054mg/m³; Formaldehyde Emissions Rate: <2µg/m³

Sustainability Performance



Sustainability Performance Details

EchoPanel achieves GreenTag Certification GreenRate: Level A & Health Rate Platinum, Red List Free, and has an International Living Future Institute Declare Label.

Instructions

Additional Information

See Woven Image EchoPanel® Care & Cleaning Guide.

Exact colour matching cannot be guaranteed between batches. Fibre mix and web variation are natural characteristics of this product.

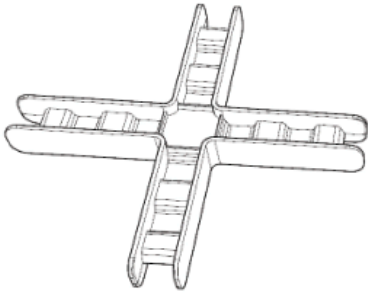

Joiner X

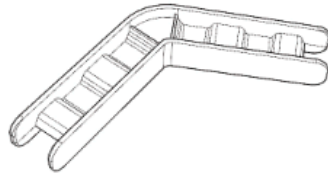

Joiner 120

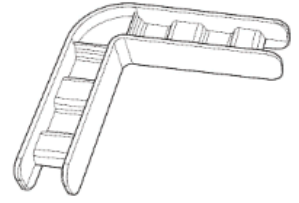

Joiner 90

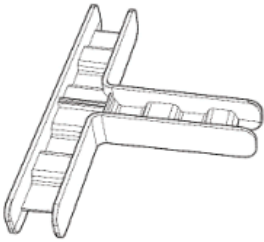

Joiner T

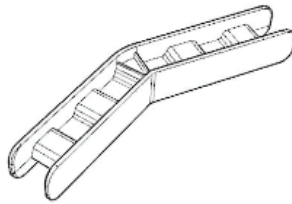

Joiner 150

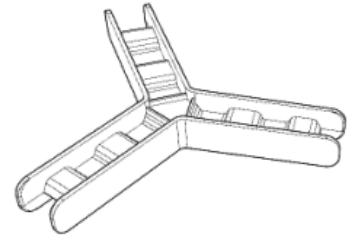

Joiner Y

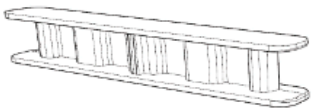

Joiner Straight

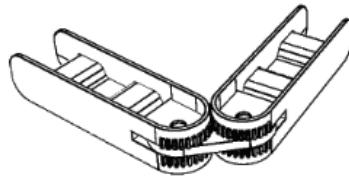

Joiner Pivot

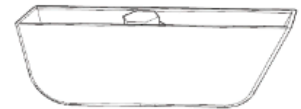

Foot Adjuster

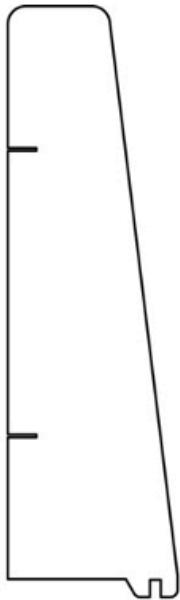

End Tall
Wrap A
475 x 1650mm

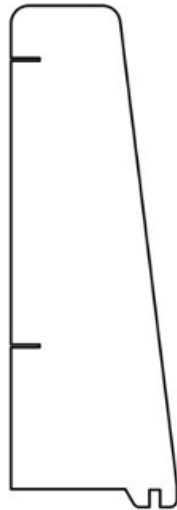

End Short
Wrap B
464.5 x 1400mm

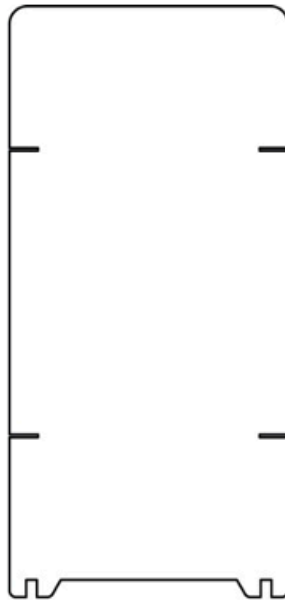

Flat Tall
Wrap C
780 x 1650mm

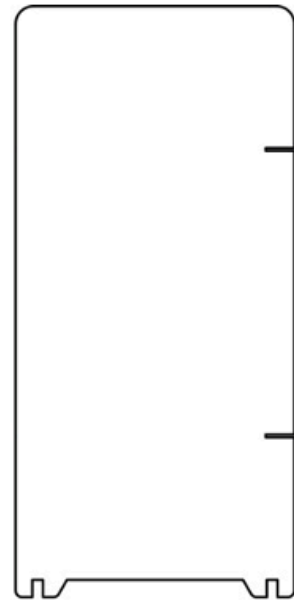

Flat Tall End
Wrap C2
780 x 1650mm

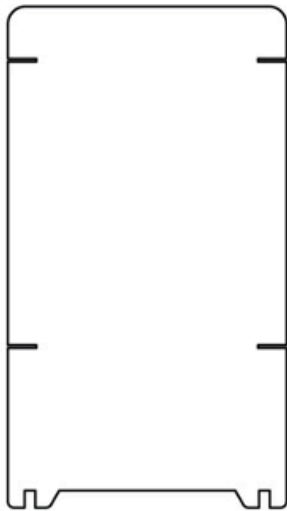

Flat Short
Wrap D
780 x 1400mm

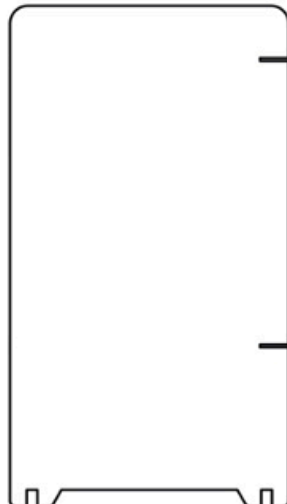

Flat Short End
Wrap D2
780 x 1400mm

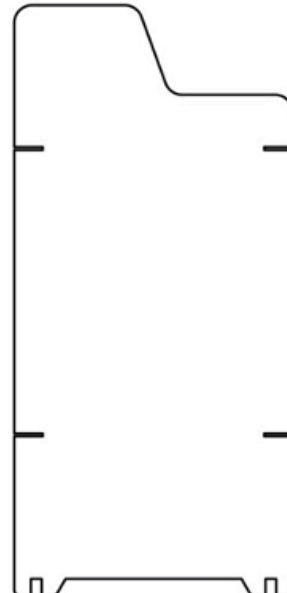

Step Up
Wrap E
780 x 1650mm