

# EchoPanel® Element

**Designer:** Woven Image

**Application(s):** Ceilings

## Composition & Pattern

**Composition** 100% PET (60% post-consumer recycled)

**Hardware Composition** ABS Plastic & Steel

**Colours Available** 3

## Kit & Box Content

**Box Contents** 8 x EchoPanel® Blades & 2 x Ceiling Clip 24mm Kits

**Component Details** x2 Ceiling Clip 24mm Kits  
16 x Ceiling grid clips  
16 x Panel clips  
16 x E-clips  
16 x Washers

24mm Suspension kit includes (sold separately):

4 x Ceiling fixtures

4 x Steel cables (Length: 2000mm & Thickness: 1.5mm per cable)

## Dimensions & Weight

**Dimensions** (Overall assembly) Length: 2350mm (+/- 2mm), Width: 2350mm (+/- 2mm), Depth: 215mm (+/- 5mm), Panel Thickness: 24mm (+/- 7%)

**Unit of Sale** Box

**Unit of Sale Net Weight (kg)** 14

## Performance

**Fire Test Result** ISO 9705: Group 1, BS EN 13501.1: Classification B - s1, d0, ASTM E84 Unadhered: Class 1 or A

**Acoustic Performance Standard Test Method** AS ISO 11654: 2002 (2016), ASTM C423 - 17

**Noise Reduction Coefficient (NRC) Result** Direct fix: 0.35, 200mm air gap: 0.35

**Sound Absorption Average (SAA) Result** Direct fix: 0.36, 200mm air gap: 0.35

**Weighted Sound Absorption Coefficient ( $\alpha_w$ ) Result** Direct fix: 0.40, 200mm air gap: 0.35

**Sound Absorption Class** D (Direct fix)

**Equivalent Absorption Area ( $A_{eq}$ ) in  $m^2$  Sabins** Direct fix: 1000Hz = 4.37m<sup>2</sup>

**Additional Acoustic Information** H = High Frequency & MH = Mid to High Frequency

**Colour Fastness to Light Standard Test Method** ISO 105 B02

**Colour Fastness Light Rating** 6 - 7

## Sustainability

**VOC Emissions Results** EchoPanel 24mm achieves ASTM D5116: TVOC Emissions Rate: <0.02mg/m<sup>2</sup>/hr (7 days), and CDPH Standard Method v1.2: TVOC Emissions Rate: <0.054mg/m<sup>3</sup>; Formaldehyde Emissions Rate: <2µg/m<sup>3</sup>

## Sustainability Performance



### Sustainability Performance Details

EchoPanel achieves GreenTag Certification GreenRate: Level A & Health Rate Platinum, Red List Free, and has an International Living Future Institute Declare Label.

## Instructions

### Additional Information

See Woven Image EchoPanel® Care & Cleaning Guide.  
See Woven Image EchoPanel® Element Installation Guide.

Exact colour matching cannot be guaranteed between batches.  
Fibre mix and web variation are natural characteristics of this product.

## Element Kit Contents:

1 x Installation guide

8 x Cut EchoPanel® Blades (100% PET 60% Recycled)

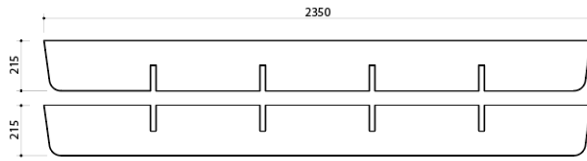

2 x Ceiling Clip 24mm kits (ABS plastic) - Total of 16 of each:

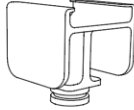

Ceiling Grid Clip

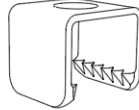

Panel Clip



E-Clip



Washer

## Overall assembly:

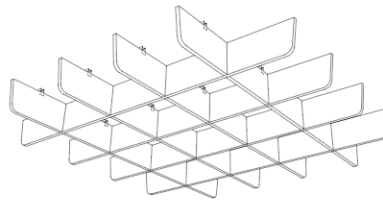

### Direct to ceiling grid

Exploded view

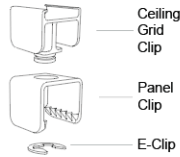

Assembled view



### Screw fix direct to ceiling:

Exploded view

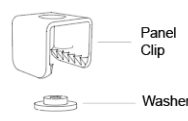

Assembled view  
(screw not provided in kit)

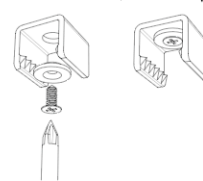

### Suspended

Shown installed with 24mm Suspension kit (sold separately):

24mm Suspension Kits are sold separately and designed for use with the Ceiling Clip 24mm Kits to connect to Element or other 24mm EchoPanel® baffle designs.

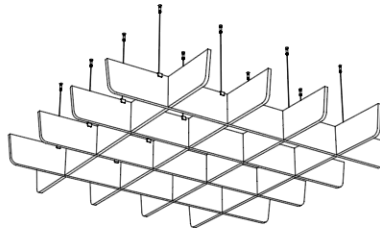

PLEASE SEE ELEMENT INSTALLATION GUIDE FOR FURTHER INFORMATION