

ECHOPANEL® ARRAY (direct fix)

INSTALLATION GUIDE



This guide is presented in good faith to assist in the installation of EchoPanel® Array. It is not intended as an all-encompassing guide, and a professional qualified installer is recommended for optimum results.

Woven Image accepts no responsibility for installation actions taken or not taken. Please refer to Woven Image Pty Ltd. Terms of Trade.

This installation guide contains only recommendations; if you have any questions about installation techniques please contact your distributor or Woven Image sales representative.

Please note:

- Please check that all ceiling baffles are the correct colour, shape, are undamaged and have the same batch number (if requested).
- No claims will be accepted after EchoPanel® Array has been installed.
- EchoPanel® Array's acoustic performance will alter based on a variety of factors including the thickness of the baffles and the spacing between them.

HARDWARE

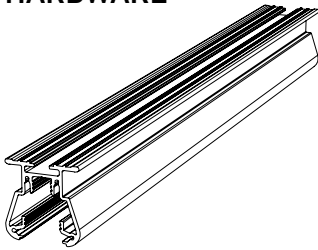

Array 2.5m rail

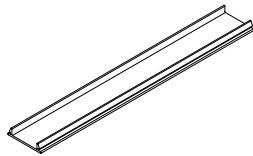

Array 2.5m snap cover

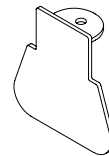

Array end cap



Array tek screw

TOOLS REQUIRED

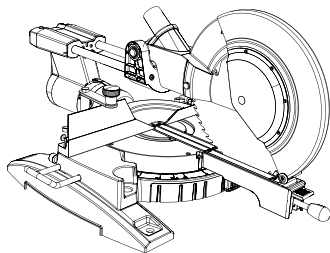

Drop saw

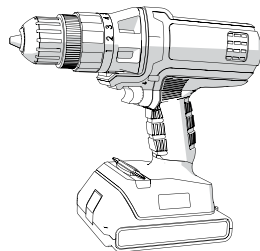

Drill

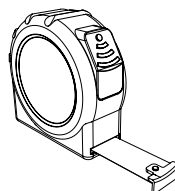

Measuring tape

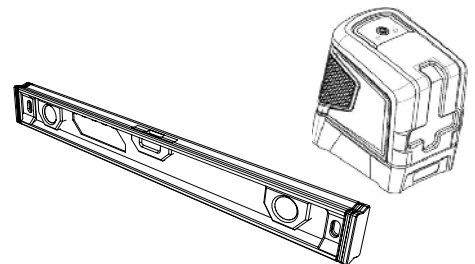

Spirit & Laser levels

ECHOPANEL® ARRAY (direct fix)

INSTALLATION GUIDE



PERPENDICULAR INSTALLATION

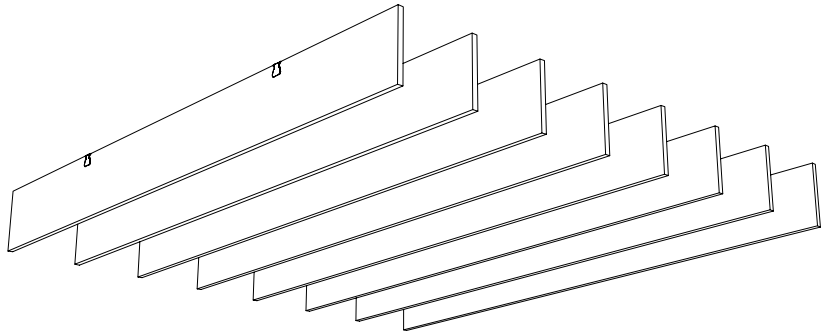

Step 1

- Inspect ceiling surfaces and structure to ensure it is free from damage and is structurally fit for installation. Level 3 plasterboard finish for a ceiling is recommended.
- Prepare area and use a laser line to mark off fixing points.

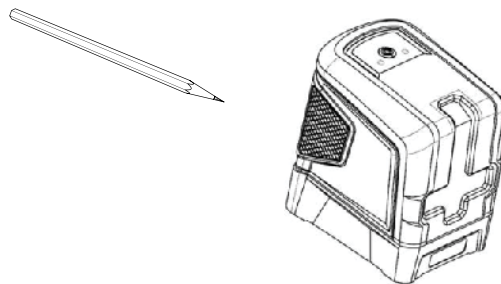

Step 2

- Using the supplied screw, attach one of the end caps to the rail.

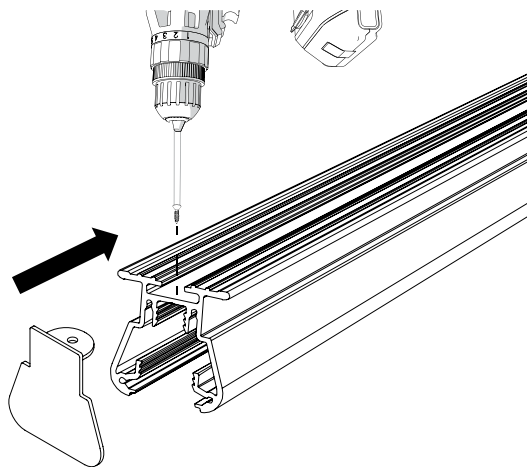

Step 3

- After pre-drilling clearance holes in the rail, attach to a structural member, aligning with marked fixing points on the ceiling.
- Continue to install the remaining rails following the same method, ensuring spacing between the rails is parallel.

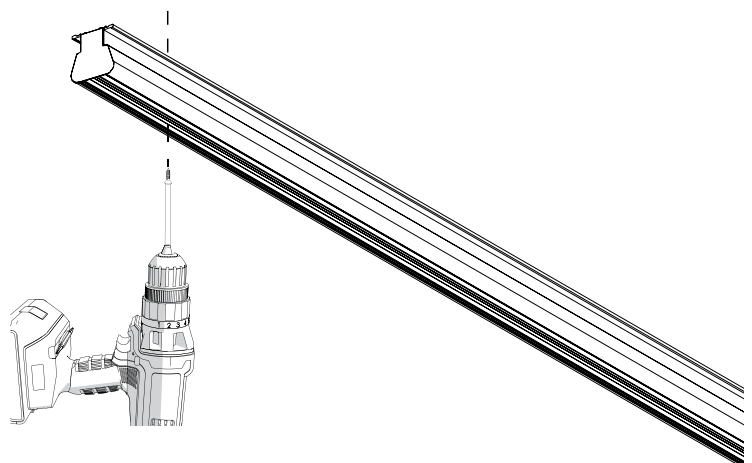

ECHOPANEL® ARRAY (direct fix)

INSTALLATION GUIDE



Step 4

- Trim the snap covers to the required length using a drop saw as outlined in the installation guide or project drawings.

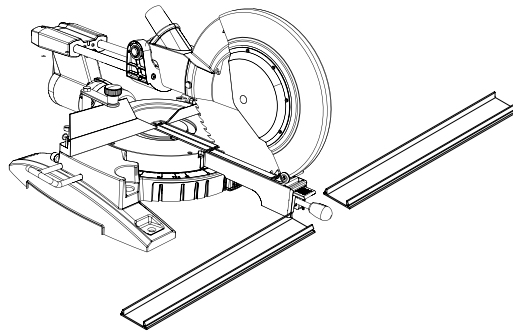

Step 5

- Slide the first baffle flush to the edge of the aluminium rail.

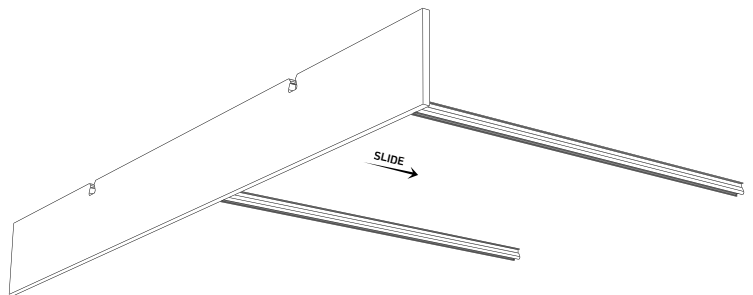

Step 6

- Insert the snap cover near the first installed baffle and slide across.

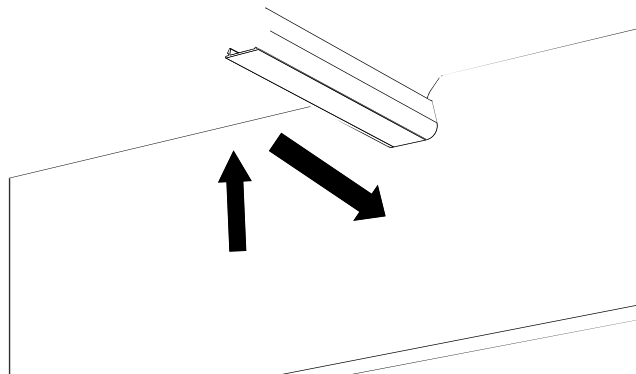

Step 7

- Continue to install the remaining baffles and snap covers following the same method.
- Finish and secure the end of the rail with the remaining end cap.

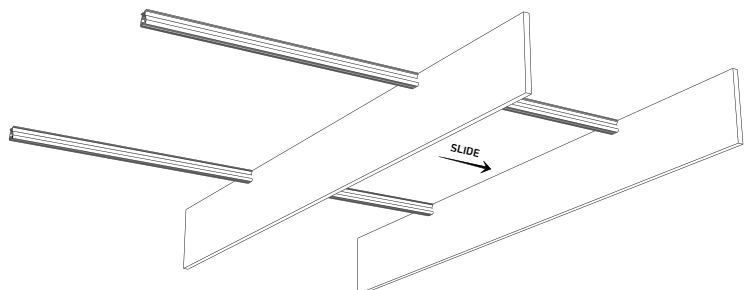

ECHOPANEL® ARRAY (direct fix)

INSTALLATION GUIDE



PARALLEL INSTALLATION

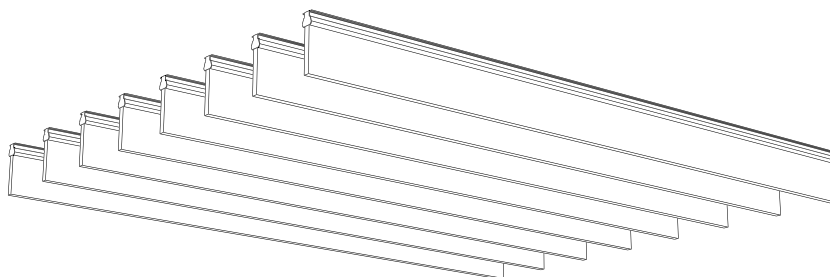

Step 1

- Follow steps 1-4 of Perpendicular Installation.

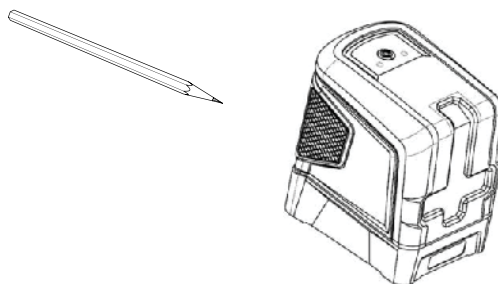

Step 2

- Insert baffles flush to the rail.

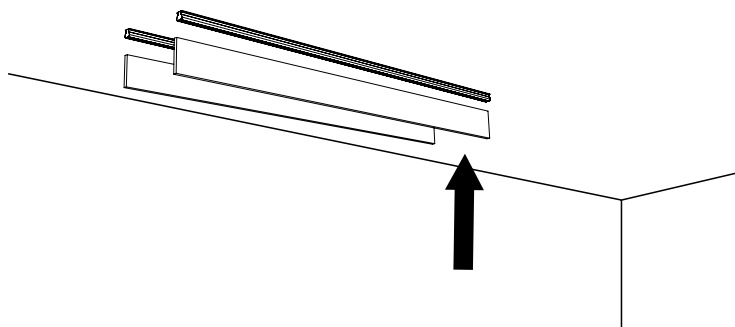

Step 3

- Using self-tapping tek screws, lock the baffle into the profile from the side.

